

Yellow ring should be made of harder cardboard and is used to secure the limb.  
After putting it on, tap it with glue.

## Upper torso

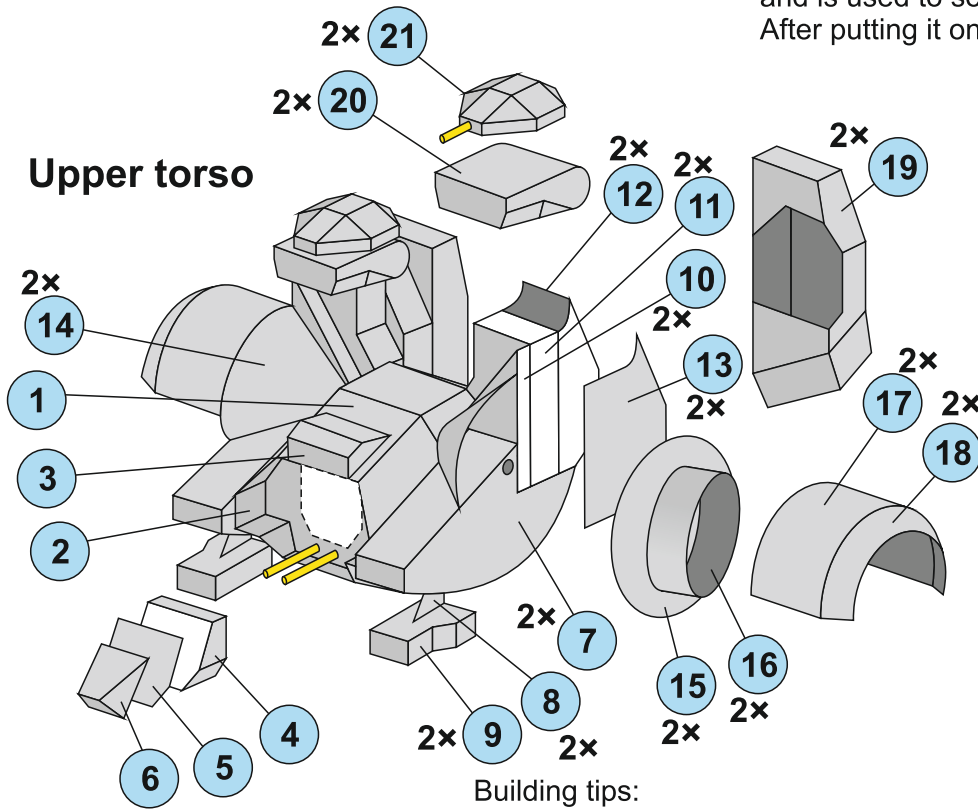

### Building tips:

The model is one of the more difficult ones.

I recommend to follow the reference photos and proceed slowly and assemble the limb parts first and then join them.

You can build the model in a non-moving version in its own position or with moving parts.

I recommend connecting them with small round rods(round toothpicks or lollipop sticks work well, or small magnets) Use similar materials to complete the details such as the gun turrets under the cockpit, on the arms and the hydraulics on the feet.

Here you have all the necessary parts and now it's up to you. You can upgrade, enlarge or modify the model in any way you like.

I wish you a pleasant build.

## Arm

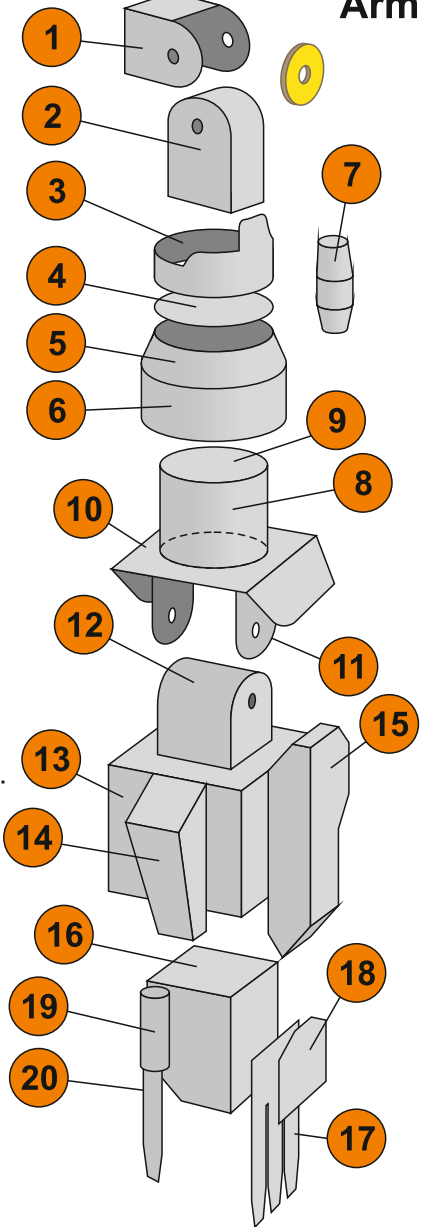

Part 15 looks a little different on each hand.

## Leg

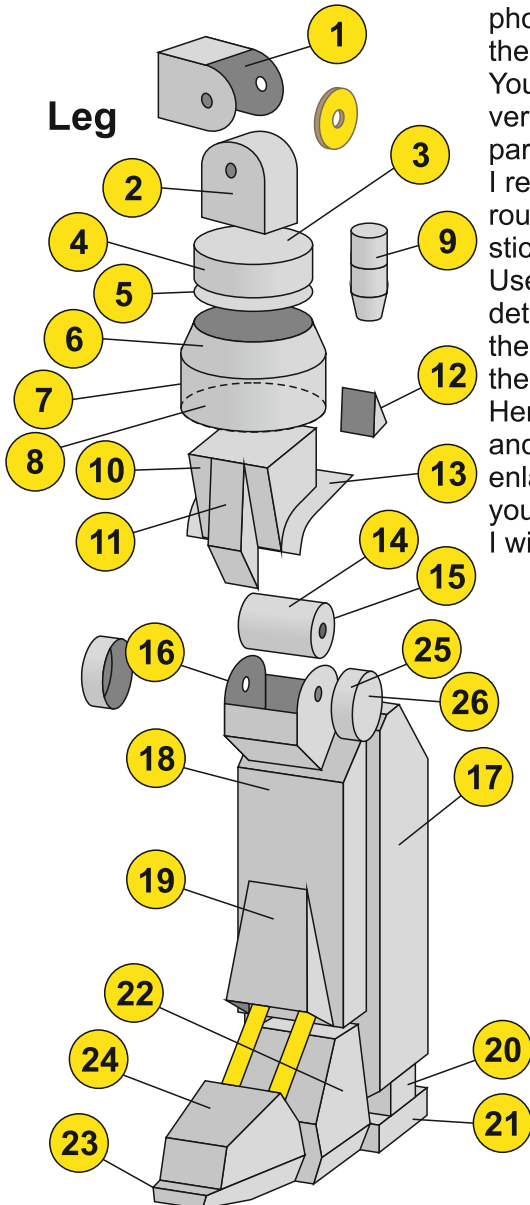

## Lower torso

